

IMMERSION I

NEW STUDENT ORIENTATION

August 20, 2025



COLLEGE OF NURSING

SETON HALL UNIVERSITY

CAMPUS GUIDE, PROGRAM HANDOUTS AND IMPORTANT
INFORMATION



What Great Minds Can Do

TABLE OF CONTENTS

3	AGENDA
5	GREETINGS FROM THE DEAN
6	WHO'S WHO IN THE COLLEGE OF NURSING
7	SIGNING ONTO THE GUEST NETWORK
9	DUO NOTIFICATION
10	I.H.S. CAMPUS PARKING RULES AND REGULATIONS
12	I.H.S. CAMPUS FIRST FLOOR MAP
13	I.H.S. CAMPUS SECOND FLOOR MAP
14	I.H.S. CAMPUS THIRD FLOOR MAP
15	CAMPUS I.D. OFFICE INSTRUCTIONS
16	COUNSELING AND PSYCHOLOGICAL SERVICES (CAPS)
17	OFFICE OF DISABILITY SUPPORT SERVICES
18	CAMPUS RESOURCES
20	OFFICE OF STUDENT ENGAGEMENT SERVICES FOR STUDENTS
21	I.H.S. STUDENT FOOD PANTRY
23	OFFICE OF STUDENT ENGAGEMENT SCRUB RACK
24	OFFICE OF STUDENT ENGAGEMENT DOVE
25	SETON HALL UNIVERSITY LIBRARIES
26	GRADUATE ASSISTANTSHIPS
28	MICROSOFT TEAMS
33	TITLE IX
34	BASIC HEALTH ASSESSMENT REFRESHER COURSE
35	GAMMA NU
39	OVERALL EVALUATION FOR IMMERSION I – AUGUST 20, 2025



GRADUATE NURSING ORIENTATION – IMMERSION I

August 20, 2025

Time	Topic and Speaker	Location
8 am	Registration and SHU IDs distributed Gabby C. Zengewald, PhD - Assistant Dean for Graduate Student Affairs, Enrollment, and Compliance Adrienne Evans - Secretary, Graduate Department	Winter Garden Lobby
8:30 am	Welcome and Introductions – Meet & Greet Interim Dean Kristi Stinson Dr. Mary Ellen Roberts Dr. Diane McClure Dr. Joyce Maglione Dr. Teresa Conklin Dr. Dorothy Carolina Dr. Moira Kendra Kathryn Tarpey-Balsamo, CPNP Dr. Elizabeth Van Dyk “If We Could See Inside Other Hearts” – A Cleveland Clinic Video Presentation	Auditorium
9:00 am	Breakout sessions with Program Directors (Acute, FNP, Nurse Exec and PNP, AGPC)	Auditorium
Program	Program Director	BREAKOUT ROOM
M.S.N. in Psychiatric-Mental Health Nurse Practitioner	Professor Kathryn Tarpey-Balsamo	3515
Nursing Administration and Executive Nurse Leadership	Dr. Dorothy S Carolina	3330
M.S.N. in Pediatric Primary Care Nurse Practitioner	Dr. Diane McClure	3118
M.S.N. in Adult-Gerontology Acute Care Nurse Practitioner	Dr. Moira E Kendra	3417
M.S.N. in Family Nurse Practitioner	Dr. Elizabeth VanDyk	3419
M.S.N. in Adult-Gerontology Primary Care Nurse Practitioner	Dr. Joyce L. Maglione	2118
10 am	Financial Aid session Samira Smith Associate Director, Financial Aid	Auditorium
10:30 am	PirateNet (Office 365, Portal) Remote Proctoring, Honorlock Canvas, BB Organizations Riad Twal Senior Instructional Designer, TLTC	Auditorium

AGENDA



COLLEGE OF NURSING

SETON HALL UNIVERSITY

12 pm	Lunch provided	3416, 3418 and 3420
1:00 pm	History of Nurse Practitioner Movement Dr. Mary Ellen Roberts	Auditorium
1:30 pm	SHU Library Databases and an Introduction to Zotero as a Research Tool Emily Cerri, Lecturer, Health Sciences Library, Jane Ogora, MLS, MBA Lecturer, Health Sciences Library	Auditorium
2:15 pm	Online Education – A Perspective from a Recent Graduate TBD	Auditorium
3:00 pm	Introduction to Advanced Pathophysiology Katherine Hinic, PhD, RN, CNE, CNL Assistant Professor, Graduate Department	Auditorium
4:00 pm	Recap and review	Auditorium

GREETINGS FROM THE DEAN



COLLEGE OF NURSING

SETON HALL UNIVERSITY

Dear Incoming Graduate Nursing Students –

It is a pleasure to welcome you to the College of Nursing at Seton Hall University. We are delighted that you have chosen Seton Hall for the continuation of your nursing education.

As you are all aware, nursing education is constantly changing to keep up with the rapidly changing healthcare environment. This is a very exciting time for nursing, and advanced practice nurses have proven to be vital members of the healthcare team to ensure the health of our nation. We are fortunate to have a diverse student population in the College of Nursing which mirrors the population for whom our graduates will be caring. Being a diverse group of students with different learning styles and needs, we have many experienced faculty and varied programs and resources available to assist you to achieve positive educational outcomes.

Thank you for your decision to advance your nursing education and your commitment to the nursing profession.

Please let us know if you have questions.

Take care and welcome!

Kristi J. Stinson, PhD, RN, APN-BC
Interim Dean and Associate Professor
Seton Hall University College of Nursing



COLLEGE OF NURSING
SETON HALL UNIVERSITY

DR. KRISTI STINSON

PhD, RN, APN, PNAP
Interim Dean and
Associate Professor



DR. GABRIELE ZENGEWALD

Assistant Dean for
Graduate Student Affairs,
Enrollment and
Compliance



DR. MARY ELLEN ROBERTS

DNP, RN, APN, C., FNAP,
FAANP, FAAN
Professor & Graduate
Department Chair,
Program Director Doctor of
Nursing Practice Program



DR. DOROTHY CAROLINA

Ph.D., RN
Program Director Nursing
Administration and
Executive Nurse
Leadership



DR. MOIRA KENDRA

DNP, MA, RN, ACNP-BC
Program Director M.S.N.
Adult-Gerontology Acute
Care Nurse Practitioner



DR. JOYCE MAGLIONE

PhD, ANP-BC, FNAP
Program Director M.S.N.
Adult-Gerontology Primary
Care Nurse Practitioner



DR. DIANE MCCLURE

DNP, CPNP, APHN-BC,
CNL, CCAP, CCRN,
CEIM, HSMI
Program Director M.S.N.
Pediatric Primary Care
Nurse



PROF. KATHRYN TARPEY-BALSAMO

MSN, APN-C, CPNP,
PMHNP-BC
Program Director M.S.N.
Psychiatric-Mental Health
Nurse Practitioner



DR. ELIZABETH VANDYK

Program Director M.S.N.
Family Nurse Practitioner



2025 - 2026

SIGNING ONTO THE GUEST NETWORK

The IHS campus additionally offers an open wireless "hotspot" style guest wireless network, like you would find at your local coffee shop, bookstore, etc.

- On your device look for and connect to wireless network called "guest".
- Your default web browser should launch, if not please launch your browser of choice (i.e. MS Internet Explorer, Google Chrome, Mozilla Firefox, etc). If you are presented with a security alert page, please choose the "I understand the risks" and/or "Advanced" option and proceed to website.
- On the first page choose the "Register for Guest Access" selection (see the picture below)

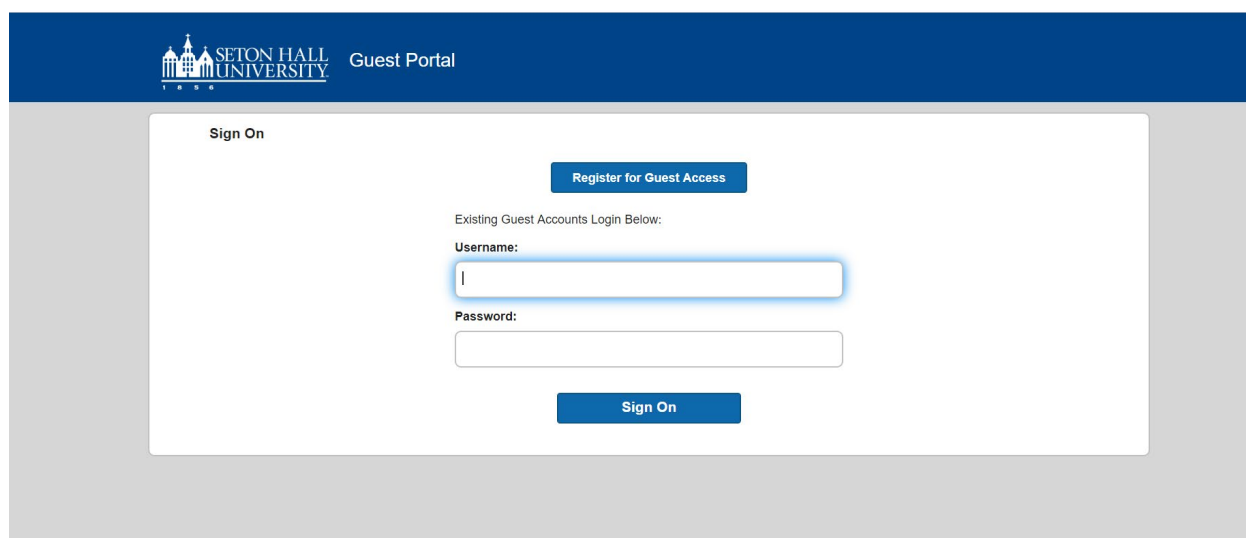

The screenshot shows the Seton Hall University Guest Portal. At the top, there is a blue header with the Seton Hall University logo and the text "Guest Portal". Below the header, the page is titled "Sign On". There is a blue button labeled "Register for Guest Access". Below this button, the text "Existing Guest Accounts Login Below:" is displayed. Underneath, there are two input fields: "Username:" and "Password:". The "Username:" field is currently empty. Below the "Password:" field, there is a blue button labeled "Sign On".

- Fill out the resulting form, (see the picture below)

SIGNING ONTO THE GUEST NETWORK

- Fill out the resulting form, (see the picture below)

The screenshot shows the 'Guest Portal' header with the Seton Hall University logo. Below it is a 'Registration' section with the instruction 'Please complete this registration form:'. The form contains the following fields: 'First name' (highlighted with a blue glow), 'Last name', 'Email address*', 'Mobile number*', 'Company', 'SMS provider*' (a dropdown menu with 'ATT' selected), 'Person being visited(email)', and 'Reason for visit'. At the bottom are 'Register' and 'Cancel' buttons.

- Please note: your email address and your mobile telephone number are required in order to connect to the guest network.
- Also make sure to select your cell phone carrier, by default "ATT" is selected.
- Once you have filled out the informational form you will be asked if you wish the network to either email you and/or text you the login details.
- Access the email address you specified or check your mobile text message app for your unique username and password to access the network.
- Plug this information back onto the login screen to connect to guest wireless.

DUO NOTIFICATION



INFORMATION TECHNOLOGY

SETON HALL UNIVERSITY

Duo Two-Factor Authentication

Two-factor authentication, sometimes referred to as multi-factor by your bank or credit card, adds a second layer of security to PirateNet. Two-factor helps to prevent anyone but you from logging in, even if they know your password. To preview the enrollment process, please review the [enrollment guide](#).

If you have already enrolled and would like to update your phone number, phone, or other authentication method, open the Duo 2FA app in PirateNet.



You can still use Duo even when you don't have wireless coverage or cell service. If you have Duo set to automatically send a push notification or call your device, just click Cancel at the bottom of the webpage.

Next, click the green Enter a Passcode button on the webpage. Open the Duo app and tap Seton Hall University to generate a passcode, enter it on the webpage, and click the green Log In button.

When possible, we encourage you to use the "Push" option because it is the fastest, most efficient authentication method.

IHS CAMPUS PARKING RULES AND REGULATIONS

The Interprofessional Health Sciences Campus (IHSC) maintains parking facilities to meet the needs of the students, faculty, staff and visitors. The IHSC does not assume responsibility for security of vehicles or contents while parked on IHSC property. Parking and operating a motor vehicle on the IHS Campus is a privilege. Please see the campus map detailing where you are allowed to park for Immersion I. If you park adjacent to Lot #1 South on Medicine Way, you can park for free. If you park in any of the other locations highlighted in yellow, the cost will be \$10.00 for the day.

South Lot (Student Lot)

Hours: 24 Hours

Parking Available: Student Permits and Reserved

Permit Types Permitted: CM (Commuter) and RM (Resident)

East Lot (ADA Lot)

Hours: 24 Hours

Parking Available: ADA

Permit Types Permitted: All

IHSC Parking Garage (Entrance Located on Ideation Way)

Hours: 24 Hours

Parking Available: Faculty, employee, students and visitors

Permit Types Permitted: All and daily fees

Definitions of Lot Descriptions

- General – Legal parking allowed with an appropriate permit.
- Visitor – Non-community members would require purchasing the \$10 daily parking fee.
- Reserved – Legal parking allowed with the specified permit category and/or license plate number.
- ADA – State issued permanent or temporary permit MUST be displayed in addition to appropriate parking permit. If the permit holder is not authorized to park in a specific lot they cannot use the ADA space in that lot.

If there are not ADA spaces available, the permit holder is NOT authorized to park in a reserved space.

IHS CAMPUS PARKING RULES AND REGULATIONS



METRO BOULEVARD

BUILDING 100

- Ralph Lauren Corporation

BUILDING 200

- Eisai Inc.

BUILDING 123

- Hackensack Meridian School of Medicine
- Seton Hall University College of Nursing
- Seton Hall University School of Health and Medical Sciences
- HMH North Regional Offices
- HMH Research Integrity Office

BUILDING 123 A

- HMH Center for Discovery and Innovation Annex

IDEATION WAY

BUILDING 111 (formerly 102)

- HMH Center for Discovery and Innovation

PARKING

Metro Boulevard

- Metered street parking - B123 Visitors Only

Metro Boulevard and Prism Street

- Lot #1 North – Permit required

Metro Boulevard and Medicine Way

- Lot #1 South – GATE CONTROLLED - Students Only

Medicine Way

- Street parking open to public

Ideation Way

- Street parking - B111 (102) Tenants and Visitors Only
- Lot #2 – B111 (102) Tenants Only
- HMH Garage - GATE CONTROLLED
 - West Entrance - Students, B123 Staff & Visitors
 - South Entrance - B111 (102) Tenants & Visitors
 - Permit/Access Card Required
 - Visitor Daily Parking Fee \$10.00
- Lot #77 - Prism Partners Only

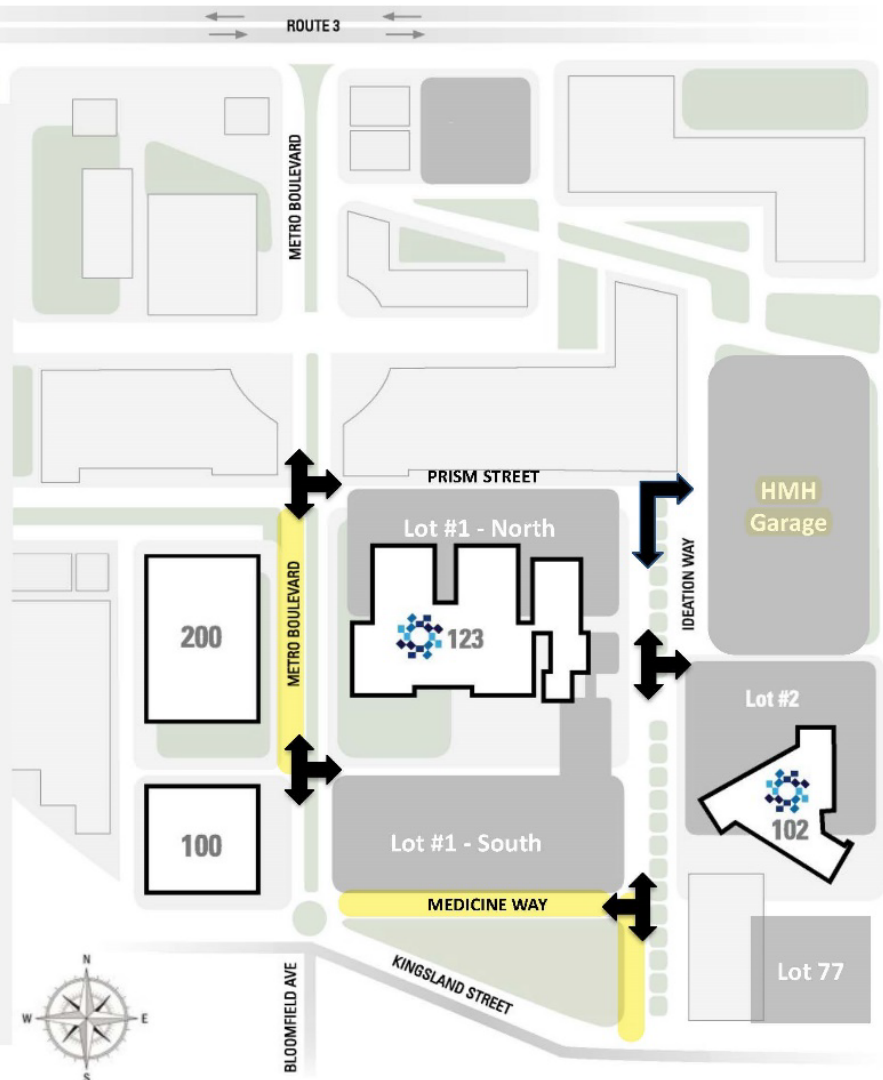

I.H.S. CAMPUS FIRST FLOOR

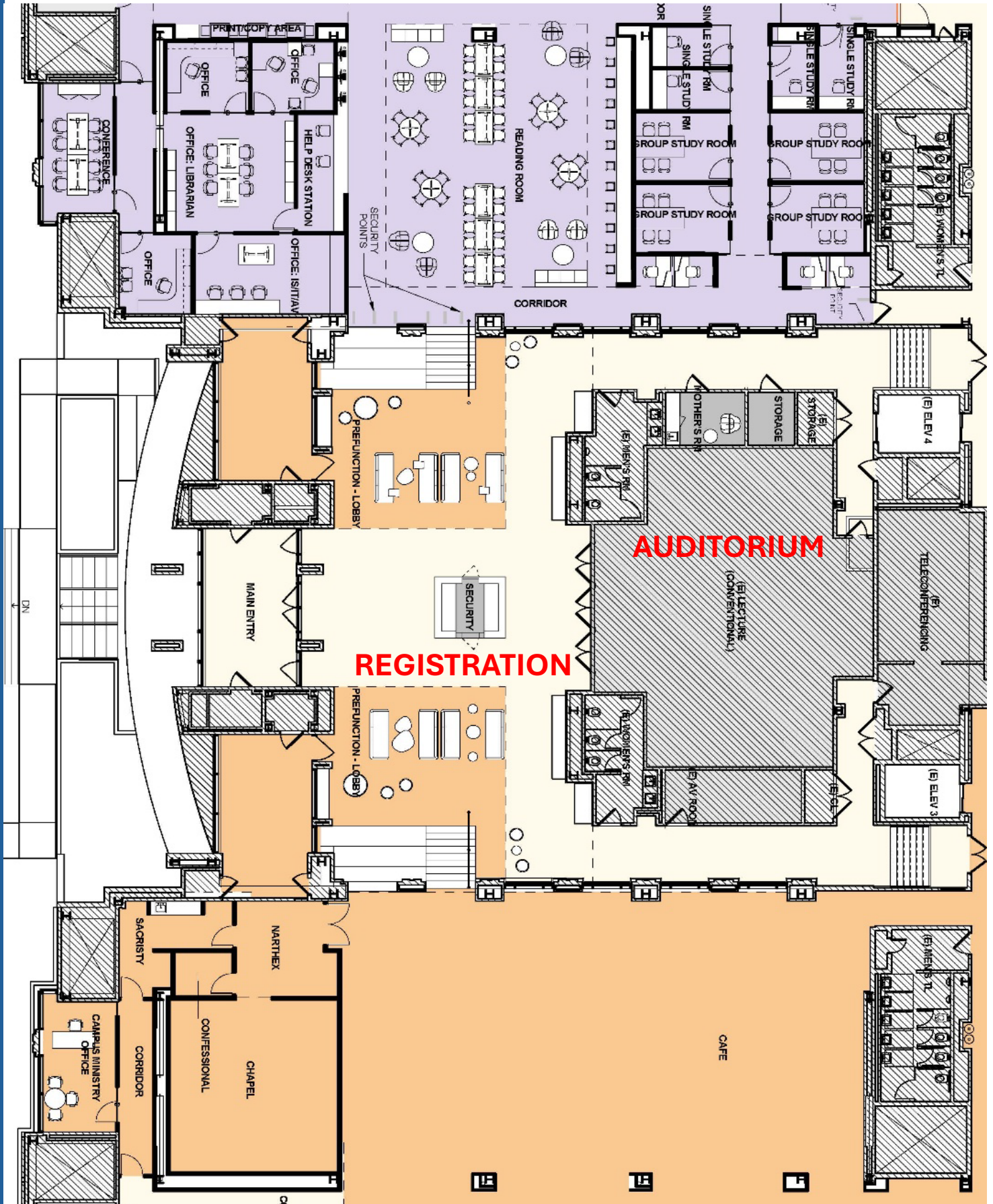

I.H.S. CAMPUS SECOND FLOOR



I.H.S. CAMPUS THIRD FLOOR

ADMINISTRATIVE AND FACULTY OFFICES

ADMINISTRATIVE AND FACULTY OFFICES

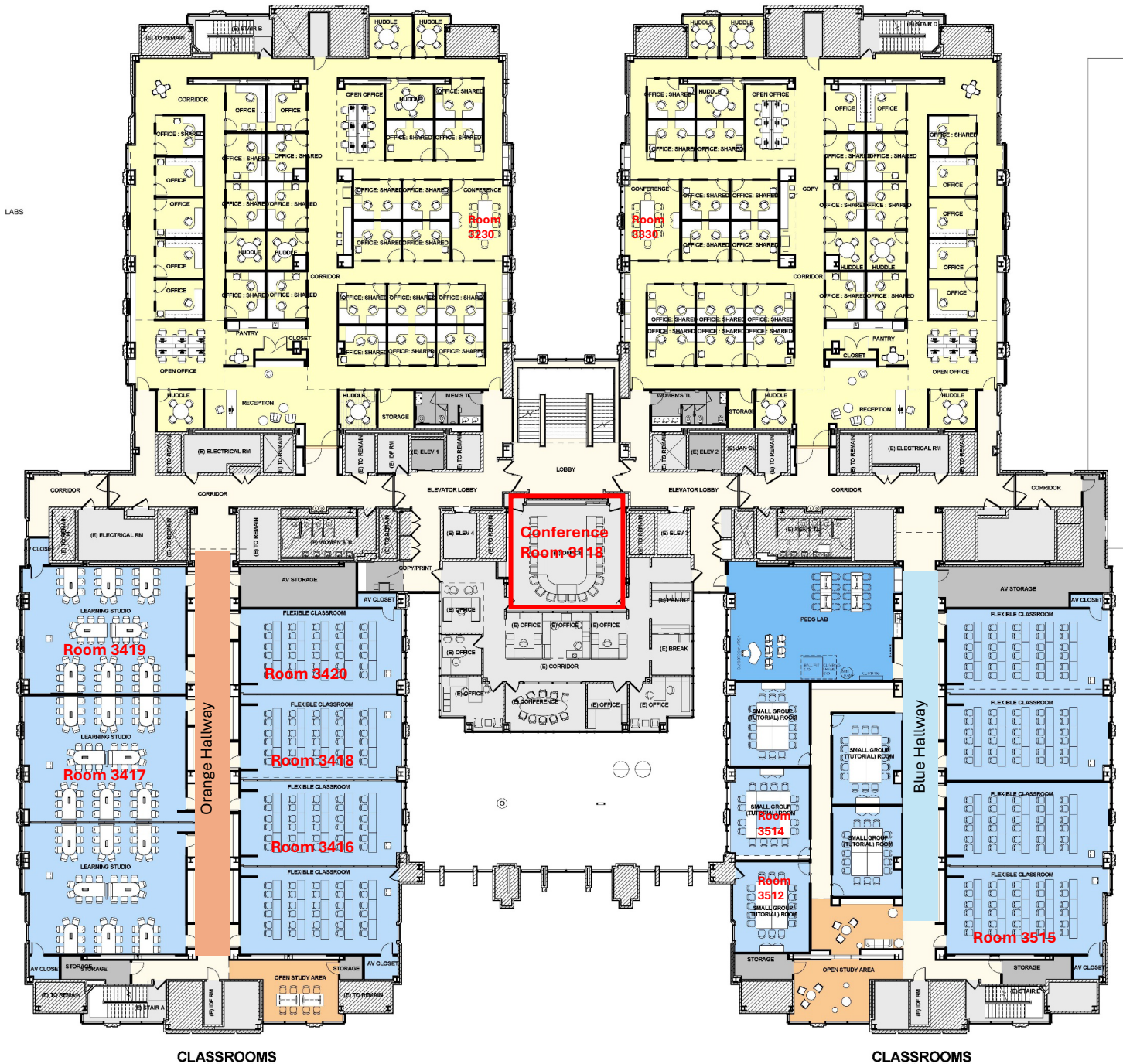

CAMPUS I.D. OFFICE

The Campus ID Office is using Online Photo submission.

After you get your PirateNet credentials, please follow instructions below to upload your photo.

1. Download the Transact eAccounts app from the Apple App Store or from the Google Play Store to your phone.
 2. Open Transact eAccounts app.
 3. Search for and select Seton Hall University.
 4. Enter your PirateNet credentials to log in.
 5. Once logged in, click on the Settings wheel in the upper-right corner.
 6. Click on Submit ID Photo.
 7. Accept the Terms and Conditions.
 8. Take note of the photo requirements and upload your photo and also a photo of your government issued ID (e.g. license, passport, etc.) to verify identity.
- Please note: This photo is different than a social media portrait. Think driver's license, not Instagram, for your ID photo.
 - Please note the Campus ID Office is observing summer hours. If you have not uploaded a photo, please do so as soon as possible.

Photo Requirements:

- Should be cropped slightly above head to middle of chest; leave some space above your head.
- Should be taken against a plain, white, smooth, non-textured background, with no ridges, indentations, shapes, or other designs.
- Must be a color photo and taken within the last 2 weeks.
- Must not include sunglasses or head coverings (e.g. hats)
- Must be positioned directly facing the camera.
- Eyes should be open and looking at the camera.
- Supporting document must be a government-issued photo ID (driver's license, passport, etc.).

COUNSELING AND PSYCHOLOGICAL SERVICES (CAPS)

Counseling and Psychological Services (CAPS) offers a wide range of confidential, therapeutic services designed to foster the psychological health and well-being of our students in order help them to thrive, develop, and achieve academic and personal success. We embrace the diversity that is embodied in the community we serve, and we acknowledge that the individual needs of our students are unique. Thus, we treat each person with respect and dignity. Through collaboration with others across Seton Hall, we work to provide programs and services that build a supportive community for all.

Confidentiality

CAPS is a confidential resource, meaning that we cannot share information with anyone outside of CAPS (including parents) without the written consent from the student. The only exceptions to confidentiality are in the event of imminent risk of serious harm to self or others.

Students seeking services or to make an appointment may contact CAPS at:

Phone: (973) 761-9500

Appointment: Monday-Friday, 8:45 a.m. to 4:45 p.m.

Location: Mooney Hall 27

OFFICE OF DISABILITY SUPPORT SERVICES

You can request services from Disability Support Services (DSS) as soon as you are admitted to Seton Hall University or, if you are already enrolled in classes, as soon as you are diagnosed with a disability. While we recommend starting this process before the beginning of the semester, you may request assistance at any time during the year. Please note, however, that accommodations are effective beginning on the date the professor is notified via the accommodation letter; accommodations are not retroactive.

To request disability support services, you will need to do the following:

- Email dss@shu.edu to identify that you are interested in seeking out services.
- We will ask you to then complete a self-identification form that DSS staff will send you. This form can only be accessed through single sign on in our AIM system using your PirateNet credentials and should only be filled out by admitted or current students. We welcome prospective students interested in learning about services to contact DSS to ask questions or set-up a phone meeting to discuss their needs.
- Next, you will need to provide comprehensive information from a licensed professional who can document your disability. You can upload this information directly to your Self-ID form, which is preferred. Alternatively, you can send these items by email, mail, or FAX. Please visit our Documentation and Forms page for documentation guidelines specific to your disability.

Campus Support for Students



QUESTION or CONCERN	CONTACT for SUPPORT
I want support for my mental health, stress, anxiety, depression, etc.	<p>Counseling and Psychological Services (CAPS) — a free, confidential service for all students. In-person, crisis, group, and teletherapy services offered.</p> <p>Dare to Care — website featuring helpful videos</p> <p>THE WELL — a toolbox of self-help resources</p>
I am struggling with basic needs like housing or food.	<p>There are many resources, both on and off campus listed on this site — Providing for Our Students' Basic Needs. Also consult with DOVE or the Dean of Students Office.</p>
I have a psychological, physical, auditory, medical, learning disability or other chronic condition and want to know about accommodations.	<p>Disability Support Services (DSS) — provides support and accommodations to assure equal access to University programs.</p>
I don't feel well. I think I might be sick. I need a vaccine or a physical. I want a wellness exam.	<p>Health Services — available to all students, regardless of insurance. Staffed by MD, NP, and RNs, and accredited by AAAHC.</p>
I want to talk with someone about a sexual assault or sexual misconduct.	<p>Title IX Office or the Dean of Students Office are available as private reporting options. CAPS, Health Services, and the Priest Community are confidential reporting options. For more information, visit the Title IX website.</p>
I experienced or witnessed a bias incident on campus and want to tell someone.	<p>Report the incident to Public Safety or the Dean of Students. The Bias Education Support Team (BEST) is available for support-related resources.</p>

Campus Support for Students

QUESTION or CONCERN	CONTACT for SUPPORT
I want to get involved on campus. I want to know what there is to do on campus.	ENGAGE! Just check out the Engage site for the current calendar and for more than 100 different organizations on campus, including their contact info.
I need a job. I need an internship. I want help with my resume. I need to improve my interview skills.	The Career Center can help with all of that and more!
I want to work on campus while in school.	For information on-campus jobs, visit Employment Opportunities at Seton Hall
I need extra help in class. I think I need a tutor.	Academic Resource Center (ARC) – provides tutors, access to Tutor.com, and study skills assistance. The best source is often the professor for the class – check out their office hours.
I missed class. What do I do?	Refer to your professors' syllabi for their absence policy. Be familiar with the University Class Absence Notification Procedure . If your absence is for 3+ consecutive days, send documentation to deanofstudents@shu.edu
I'm not sure where to go or whom to ask with my question.	Contact the Dean of Students Office . If they can't assist you, they'll direct you to the right place.

Services for Seton Hall Students

Counseling and Psychological Services (CAPS)	Jayne Duncan, PhD - 973-542-6984 caps@shu.edu
Disability Support Services (DSS)	Jacqueline Safont, J.D. - 973-542-6978 dss.ihs@shu.edu
Student Engagement	Lorraine Gardner - 973-542-6916 Lorraine.Gardner@shu.edu
Career Center	Nadia Sanon - 973-275-2822 Nadia.Sanon@shu.edu
Registrar	www.shu.edu/registrarappointment
Financial Aid	www.shu.edu/finaidappointment
Human Resources	Terri Demarest - 973-761-9181 terri.demarest@shu.edu
Bursar	Daniel McGuire - 973-275-2584 daniel.mcguire@shu.edu
Undergraduate Admissions	Joseph Puleo 973-275-2296
Health Services	SHU Health Portal 973-761-9175 Extended Telehealth: M-W 5-7PM 1-862-338-9129

IHS Student Food Pantry

ROOM 1521 IN SUITE 1500
MONDAY-FRIDAY
7AM-5PM

Take what you need, but please be mindful of others.

Please leave the pantry clean and organized for the
other students.

If you would like to donate:

Non-perishable/microwavable food items
preferably for use on campus. Hygiene products and
toiletries are also welcome.

THANK YOU!



IHS Student Food Pantry

ALL ITEMS NEED TO BE NON-PERISHABLE AND
UNOPENED TO DONATE

Microwavable (individual
servings if possible):

1. Rice cups
2. Oatmeal packets
3. Ramen noodles
4. Mashed potatoes
5. Popcorn
6. Macaroni and cheese
7. Pasta
8. Soup

Drinks:

Non-perishable, unopened drinks

Ready to Eat Individual Packets:

1. Chips
2. Cookies
3. Nuts
4. Individual Nut Butter Cups
5. Crackers
6. Fruit Cups/Dried Fruit
7. Applesauce Cups
8. Rice Cakes
9. Dry Cereal
10. Granola Bars
11. Trail Mix

Generously give to our fabulous students in
need! Students, grab what you require!

PANTRY HOURS: M-F 7 AM-5 PM

ROOM 1521





SCRUB RÄCK

Scrub Rack is a resource for **IHS students in need of scrubs** for clinical placements. If buying new scrubs feels out of reach, we've got you covered!

Browse our collection of **gently used, solid-colored** scrubs that are **free of stains and holes**



Scrubs will be located in **Suite 1500, Office of Student Engagement, Room 1521** of the suite. Students can **pick up scrubs** between the hours of **7:00 am and 5:00 pm**

Should you require special accommodations for this program due to disability, please contact DSS at 973-313-6003 prior to this event.



DOVE & IHS STUDENT SERVICES

PARTNERING WITH ALUMNI RUN NONPROFIT, S.O.F.T

MAKE 1 TAKE 1 CARE PACKAGE MAKING PROGRAM

WHO RECEIVES THESE FOOD PACKS?

- Children receiving free/ reduced lunches.
- Care packs offer relief during the weekend to students reliant on school lunches.



MORE ABOUT FOOD INSECURITY

13.8 MILLION

Children lived in households that experienced food insecurity in 2023.

1/7 HOUSEHOLDS

(13.5 percent) experienced food insecurity, or lack of access to an affordable, nutritious diet.



Welcome to IHS!

We at the library are happy to help you with all your research needs. We offer:

- A robust reference collection
- Plenty of single and group study rooms
- Research consultations with a librarian A library website dedicated to IHS resources: library.shu.edu/ihs-home
- Access to online health sciences journals and databases
- An easily accessible online toolkit compiling essential resources for nursing: <https://library.shu.edu/ihs-nursing>

If you have any questions, please don't hesitate to ask! We can be reached at:

Jane Ogora: jane.ogora@shu.edu

Emily Cerri: emily.cerri@shu.edu

GRADUATE ASSISTANTSHIPS

Graduate Assistantships

Each academic year, Seton Hall offers a limited number of graduate assistantships.

Assistantships draw on a variety of different skills and require a presence on campus 20 hours each week. You can view information on open positions and submit your application online using the online employment website: jobs.shu.edu. Open Graduate Assistantship position can be located under the "Categories" section in the left-hand navigation.

Overview

- You must be admitted to a program before you can apply for a graduate assistantship.
- To apply, you must complete the application and upload your resume, and personal statement.
- Prospective employers seeking graduate assistants, review applications, conduct interviews and hire assistants. You will be contacted if they wish to interview you for an open position.
- If you are granted an assistantship, you will work for a department or office, such as the department of Biological Sciences.

Frequently Asked Questions

What is the graduate assistantship program?

A graduate assistantship is an on-campus, part-time job for which the compensation includes both tuition remission and a small stipend. Assistantships are generally comprised of positions whose primary responsibilities may be related to teaching, research, or administrative work, and they may be available in a variety of academic departments and offices throughout the University.

Who is eligible to work as a graduate assistant?

Students who have been accepted into a degree program are eligible for assistantships. Assistantships are not available to non-matriculated students or students in certificate programs.

How do I apply for an Assistantship?

Apply for an assistantship online at jobs.shu.edu. Your complete application consists of the application form, your resume, and a personal statement.

GRADUATE ASSISTANTSHIPS

How do I get an Assistantship? How does it work?

Applications are reviewed by program directors, managers and or supervisors. You will be contacted if they wish to interview you for an open position.

Is there a deadline for applications?

There is no official deadline for applications, but most departments conduct hiring interviews in the spring semester for the following fall. There are very few mid-year appointments, so most applications are reviewed in the spring semester.

Can I apply for an assistantship at the same time as I apply to a graduate degree program?

No, you must be admitted to a degree (not certificate) program before you can be employed as a graduate assistant.

Where can I learn more about graduate assistantships?

For more information, please consult the [Graduate Assistant Handbook](#).



Microsoft Teams

Launch Microsoft Teams

Microsoft Teams is an application where people can collaborate, hold meetings, and share files. It supports private and group conversations, and synchronous virtual classes can also be conducted using Microsoft Teams.

Follow these steps to launch Microsoft Teams:



Microsoft Teams

Sign into Microsoft Teams

Once the Microsoft Teams has launched, you will be prompted to sign into a Microsoft account.

1. Enter your **<username>@shu.edu**, then select the **Next** button. *For example, if your name is Mary Smith and your username is "smithmar", you will enter "smithmar@shu.edu."*
2. You will be asked to specify if the account is a Work or school account or a Personal account. Select **Work or school account**.

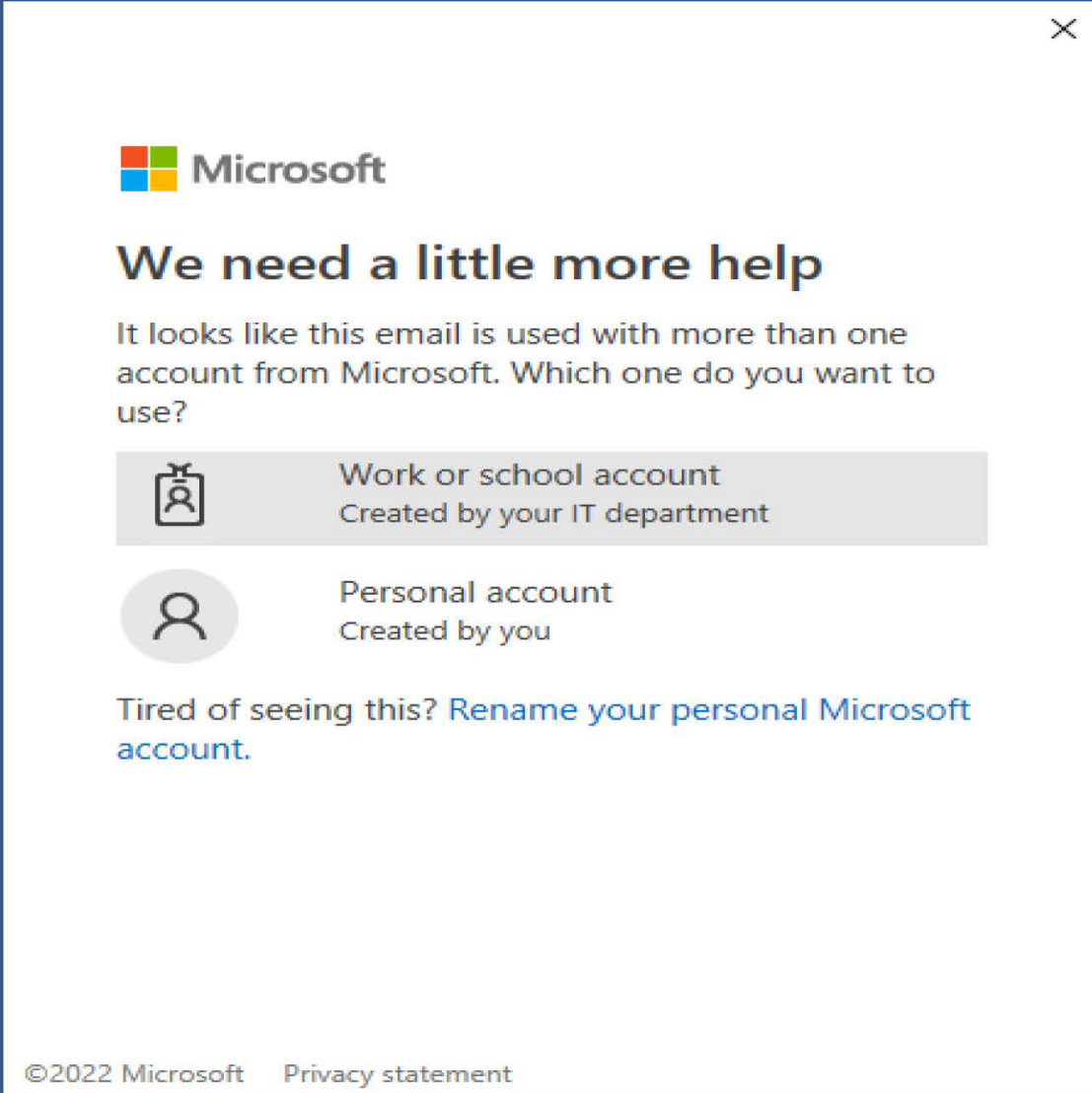
A screenshot of a Microsoft account selection window. At the top right is a close button (X). Below the Microsoft logo is the heading "We need a little more help". The text reads: "It looks like this email is used with more than one account from Microsoft. Which one do you want to use?". There are two options: "Work or school account" (Created by your IT department) with a person icon, and "Personal account" (Created by you) with a person icon. At the bottom, it says "Tired of seeing this? [Rename your personal Microsoft account.](#)". The footer contains "©2022 Microsoft" and "Privacy statement".

Microsoft

We need a little more help

It looks like this email is used with more than one account from Microsoft. Which one do you want to use?

 **Work or school account**
Created by your IT department

 **Personal account**
Created by you

Tired of seeing this? [Rename your personal Microsoft account.](#)

©2022 Microsoft Privacy statement



Microsoft Teams

3. The Seton Hall login screen will appear. Enter your **eight-character username** and **network password**. Then, click the **Sign in** button. *You may be prompted to authenticate via [Duo Two-Factor Authentication](#).*

A screenshot of the Seton Hall University Office 365 login screen. At the top, it says "Connecting to Office 365" with the Office 365 logo. Below that is the "SETON HALL UNIVERSITY" logo. The main heading is "Sign In". There are two input fields: "Username" and "Password". Below the password field is a checkbox labeled "Remember me". At the bottom is a large blue "Sign In" button. Below the button is a link that says "Need help signing in?".

Connecting to Office 365

SETON HALL UNIVERSITY

Sign In

Username

Password

☐ Remember me

[Need help signing in?](#)



Microsoft Teams

Pick a Team and Channel

A *team* is a collection of people, conversations, files, and tools — all in one place.

A *channel* is a discussion within a team, dedicated to a department, project, or topic.

The best way to get familiar with teams and channels is to pick a team and channel and start exploring!

1. Select the **Teams** icon from the left-hand navigation menu, then choose a team.
2. Select a channel and explore the **Conversations**, **Files**, and other tabs under your Team name at the top of the screen. For more info, see [Teams and channels](#).

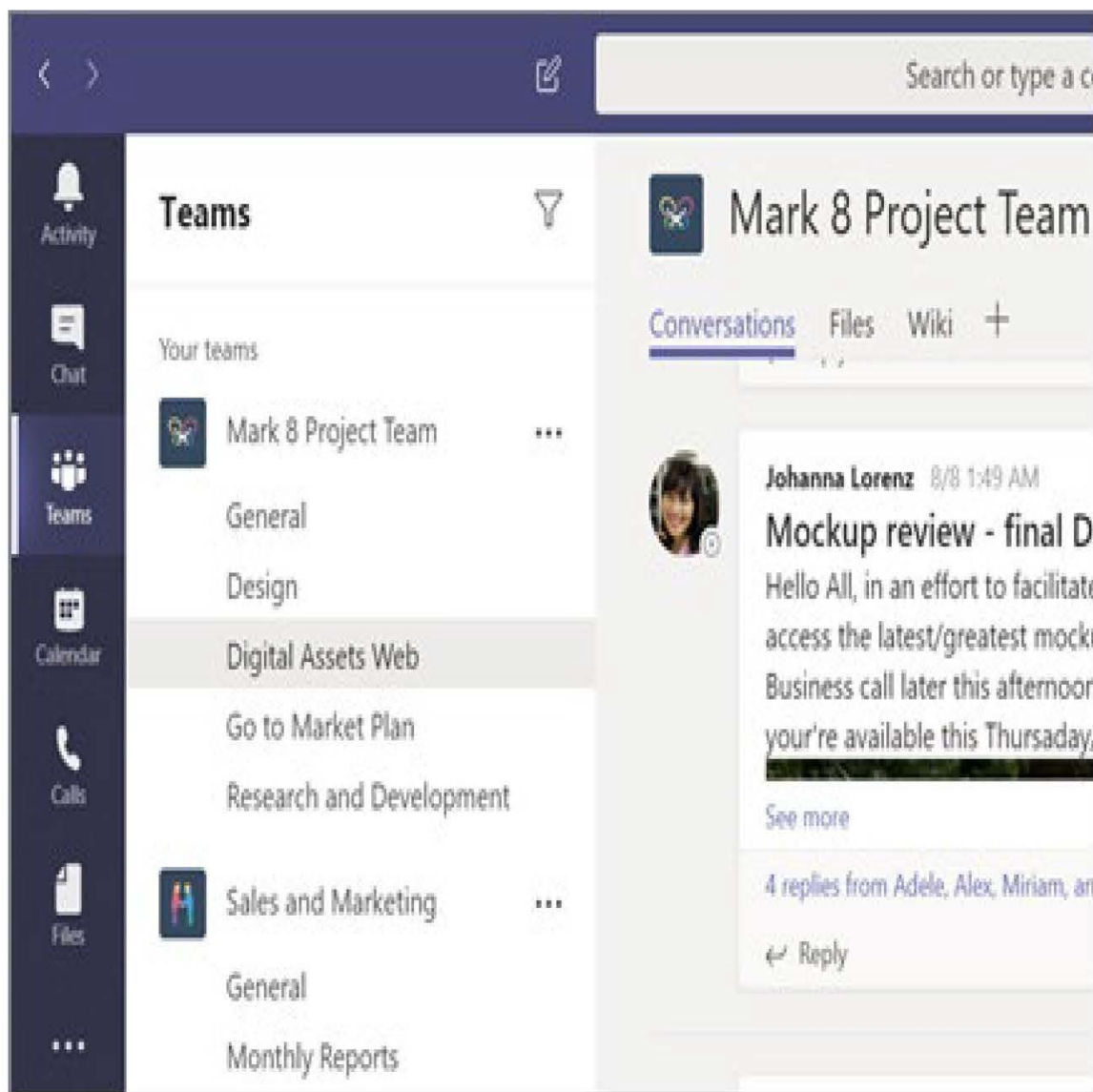



Microsoft Teams

Once you've joined, please be sure to join these Teams.

[General | nursing_majors_GRADnursing | Microsoft Teams](#)

[Scholarships | nursing_majors_GRADnursing | Microsoft Teams](#)

TITLE IX

Title IX Statement to the Community

We at Seton Hall University are committed to fostering a positive working and learning community. We take this very seriously and accept our responsibility to help both students and employees understand the guidelines that are outlined in Title IX of the Education Act. We are committed to a university free from sexual harassment and sexual assault. Anything less is unacceptable.

We pledge to work toward this goal. Seton Hall provides many opportunities for education and understanding to address concerns about sexual harassment, sexual discrimination, and sexual violence. The resources that we provide are described throughout this site. We encourage our community to read, to question and to participate in the dialogue to foster a community welcoming to all.

Monica N. Burnette, Ph.D.

Vice President of Student Services

BASIC HEALTH ASSESSMENT REFRESHER COURSE



SETON HALL COLLEGE OF NURSING OFFERS BASIC HEALTH ASSESSMENT REFRESHER COURSE

During this online course, registered nurses can further develop and hone their basic health assessment skills at their own pace, with up to three months to complete.

Self-paced, Asynchronous

SETON HALL STUDENTS: \$600

NON-SETON HALL STUDENTS: \$700

COURSE MATERIALS: \$126

CONTACT HOURS: 25*

To learn more and register, visit
www.shu.edu/BHAcourse



COLLEGE OF NURSING

SETON HALL UNIVERSITY

GOAL: Students will acquire and demonstrate proficiency of physical assessment skills in a systematic manner.

TARGET AUDIENCE: Registered Nurses,
Nurse Practitioner Students

LEARNING OUTCOME: At the completion of this program, 100% of participants will improve their proficiency to assess body systems using the four modalities of the physical examination: inspection, palpation, percussion, and auscultation in proper sequence, using proper technique, to identify normal and abnormal findings.

Planners have no conflict of interest to disclose regarding this educational activity.

*To earn a certificate for 25 contact hours, participants must complete an evaluation form, all computer-based learning modules of the program, and successfully complete a return demonstration of a head-to-toe physical assessment.

Seton Hall University College of Nursing is approved as a provider of nursing continuing professional development by New Jersey State Nurses Association an accredited approver by the American Nurses Credentialing Center's Commission on Accreditation. P196-11/23-26.

Gamma Nu is Seton Hall College of Nursing's Chapter of the International Honor Society of Nursing. Founded in 1922, Sigma has over 100,000 active members in over 60 countries.

Sigma Mission

Developing nurse leaders anywhere to improve healthcare everywhere.

Sigma Vision

Connected, empowered nurse leaders transforming global healthcare.

Chapter Regions

Sigma's chapters are separated into six global regions. The North America region is further divided into 15 geographic regions. Gamma Nu is part of Region 14.

Headquarters Information

Chapter-specific questions should be directed to the chapter's contact person listed in the chapter directory. For Gamma Nu, the contact person is Maryanne Barra-Schneider, President. If you have questions about your membership, renewals or benefits, please contact Sigma headquarters.

For more information:

Sigma Website: <https://www.sigmanursing.org/>

Sigma Phone Number: 888-634-7575

Sigma Member Email: memserv@sigmanursing.org

Informational Videos:

- [Join Sigma!](#)
- [The Future of Sigma is Here](#)
- [Join STTI](#)

Gamma Nu Website: <https://gammanu.sigmanursing.org/home>

Gamma Nu Facebook: <https://www.facebook.com/GammaNuSHU/>

After Induction/Joining Gamma Nu:

- Start networking on The Circle, Sigma's online members community and professional networking site: <https://www.sigmanursing.org/connect-engage/thecircle>. On this site, you can join interest group and discussions and access Sigma's library of resources.
- Watch for these emails: Sigma Updates, Gamma Nu Chapter Digests and others from STTI. Please check your spam for emails from: Sigma Theta Tau InternationalDoNotReply@connectedcommunity.org

Gamma Nu is Seton Hall University's Chapter of Sigma Theta Tau international. Chartered in 1978 as the 83rd Chapter, it currently has nearly 300 active members.

Criteria for Induction into Gamma Nu Chapter

Each Spring, Gamma Nu invites eligible CON students to join Sigma Theta Tau. Criteria for graduate students are:

- ✓ Completion of 25% of graduate curriculum
- ✓ GPA of 3.5 or greater
- ✓ demonstrated academic achievement, academic integrity and professional leadership potential.

Students who accept the invitation to join will be invited to the annual Induction Ceremony. Family and friends are welcome to attend this celebration.



New Gamma Nu members at the 2025 Induction Ceremony

Gamma Nu Activities include:

Meetings: Gamma Nu meets, usually virtually, most months during the academic year. All members are invited to attend.

Reinkemeyer Research Conference: The Annual Reinkemeyer Research Conference is held each spring and provides nurses and nursing students an opportunity to present their research and to learn about research conducted by others.

Induction Ceremony: Gamma Nu inducts new members each spring at a traditional ceremony and celebration. Family and friends are also welcome to attend.

Scholarships: Gamma Nu offers scholarships to nursing students at all levels. Applications for the **Carolyn F. Rummel Scholarships** are distributed each spring, and the scholarships are awarded at the Induction Celebration. Recipients must be active Gamma Nu members.

Research Awards: Financial support for research endeavors is available from Gamma Nu. Applications for the **Francisca Champion Research Awards** are distributed each winter, and the scholarships are awarded at the Induction Celebration. Recipients must be active Gamma Nu members.

Service Award: Each year, Gamma Nu awards the **Mary Ann Scharf Joy of Nursing Award** to recognize service to Gamma Nu and/ or the College of Nursing.

Book Club: Held mostly virtually, the Book Club discusses novels and nonfiction work about nurses and the nursing profession.

Magnificat Home: Gamma Nu provides financial support to the women living in Magnificat Home in Jersey City.

Gamma Nu maintains active participation in both Sigma **Region 14** and the **NJ Consortium of Sigma Chapters**. Annually, Region 14 hosts a research conference and the NJ Consortium holds a Founders Day Celebration.

If you are interested in joining Gamma Nu or volunteering on a committee, please contact Maryanne Barra Schneider, President (maryanne.barraschneider@shu.edu). For more information about the Chapter, visit the [Gamma Nu Website](#).

GAMMA NU

President: Maryanne Barra-Schneider

**Mark your
calendars for these
upcoming events**

- ❑ **Vice-President** – Diane McClure
- ❑ **Treasurer:** Carmen Cruz-Torres
- ❑ **Recording Secretaries:** Afua Ampiaaw and Susan Darby
- ❑ **Corresponding Secretary:** Susan Darby
- ❑ **Counselor/Governance Committee**
Chairperson: Luz-Patricia Torres
- ❑ **Governance Committee:** Kristi Stinson, Diane McClure
- ❑ **Leadership Succession Committee:** Patricia Hubert (Chair)
- ❑ **Reinkemeyer Research Day:** Caroline Meza (Chair), Nancy Bohnarczyk, Cathy Grano, Pam Galehouse, Katherine Black
- ❑ **Induction Committee:** Diane McClure (Chair), Katherine Black, Ivonne Guzman, Joyce Maglione
- ❑ **Awards/Scholarships:** Maryanne Barra-Schneider
- ❑ **Membership Involvement:** Pat Hubert (Chair), Awale Ugele, Denise Warren-Simmons
- ❑ **Region 14 Representative:** Denise Warren-Simmons and Maryanne Barra-Schneider
- ❑ **Philanthropy/Webmaster/NJ Consortium Representative:** Katherine Black

- NJ Consortium of Sigma Chapters Founders Day Celebration: October 5, 2025
Stage House Tavern, Mountainside, NJ
- Gamma Nu Book Club: TBA
- 38th Annual Reinkemeyer Research Day: Friday, March 13, 2026
South Orange Campus
- Gamma Nu Induction: Sunday, April 12, 2026
South Orange Campus



OVERALL EVALUATION FOR IMMERSION 1 – AUGUST 20, 2025

Using the QR Code below, Please fill out this survey at the conclusion of Immersion I. Thank you.



